

**Product Installation Guidelines & Scope of Use**

**Ezy-Push® CP-BS Timeflow Push Button Replacement Kit with Cartridge and Dress Flange**

**PRODUCT CODE:  
173.93.41.00**

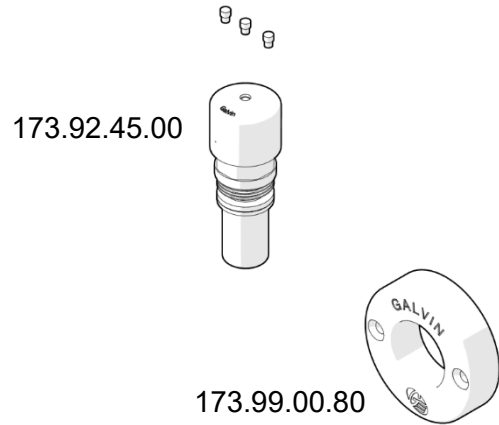

*For Watermark and/or WELS information of KITS, refer to each individually certified component.*

Item Codes:	Description	Watermark	WELS
173.93.41.00	<b>Ezy-Push® CP-BS Timeflow Push Button Replacement Kit with Cartridge and Dress Flange</b>	*	*
Components:			
173.99.00.80	Ezy-Push® CP-BS Timeflow Push Button Replacement Dress Flange	N/A	N/A
173.92.45.00	Ezy-Push® CP-BS Lead Safe™ Timeflow Push Button Repl. Cartridge for Shower 15 Sec (New Style)	YES	N/A

**Notes:**

1. N/A—Not applicable.
2. \* — The item is a **KIT**.
3. A copy of each component's Installation Instructions can either be downloaded from [www.galvinengineering.com.au](http://www.galvinengineering.com.au) or found inside the packaging.
4. Kit components may be purchased separately.

**INSTALLATION**

**INSTALLATION COMPLIANCE:** Galvin Engineering products must be installed in accordance with these installation instructions and in accordance with AS/NZS 3500, the PCA and your local regulatory requirements. Water and/or electrical supply conditions must also comply to the applicable national and/or state standards. Failing to comply with these provisions shall void the product warranty and may affect the performance of the product.

TROUBLESHOOTING		
PROBLEM	CAUSE	RECTIFICATION
Taps are dripping water	Dirt/debris in cartridge	Remove and clean cartridge
	Faulty cartridge	Replace cartridge
Water is not flowing from tap	Water is turned off	Turn on water
	Aerator or flow restrictor is blocked by debris	Remove aerator and/or flow restrictor from tap and remove debris. Install an in-line strainer.

**WARRANTY**

Galvin Engineering products are covered under our Manufacturer's Warranty. Galvin Engineering products must be installed in accordance with the installation instructions and in accordance with AS/NZS 3500 and NCC Volume Three, relevant Australian Standards and local authorities applicable to product being installed. Water and electrical supply conditions must also comply to the applicable national and/or state standards, failing to comply with these provisions may void the product warranty and affect performance of the product.

Please visit [www.galvinengineering.com.au](http://www.galvinengineering.com.au) to view the full warranty, our Installation Compliance and Maintenance & Cleaning information as well as any other additional information.

**DEFINITIONS AND DISCLAIMER**

Galvin Engineering manufactures a range of products marked as Ligature Resistant or Vandal Resistant. Please visit [www.galvinengineering.com.au](http://www.galvinengineering.com.au) to read the definition of these terms and the disclaimer that applies to these products.

